



**Use:**

Air supply or air exhaust in low and medium pressure installations.

**Fitting:**

In walls and floors (only the reinforced version KNK-T-al-2). Fitted using visible screws in holes pressed in the front frame or without visible screws using press-in fixture of the additional RM fixing frame.

**Construction:**

Front frame and blades made of pressed aluminium profiles. Blades fixed horizontally. Two versions of manufacturing: light: KNK-T-al-1 and reinforced: KNK-T-al-2. Optional straight air supply KNK-al or angular air supply KNK-al-15°. Maximum length of a single unit: 2 running meters.

**Material:**

Aluminium, alloy 6063.

**Surface finish:**

Naturally anodized aluminium or powder coat coloured according to RAL catalogue.

**Air flow regulation:**

With a counter directional damper type P. Air flow regulation can be made from the front without the necessity of dismantling the grille.

**Certificates:**

Technical recommendation: RT-ITB-1148/2010

Hygiene certificate: HK/B/1844/02/2007

**Dimensions and type marking:**

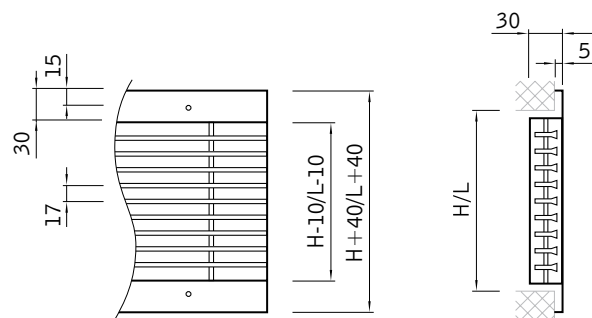

**KNK-T-al-1**

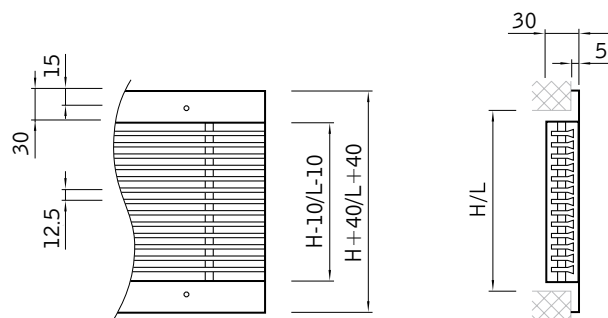

**KNK-T-al-2**

Straight air supply  
**KNK-T-al**

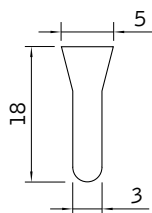

Angular air supply  
**KNK-T-al-15°**

