

**Use:**

Air flow regulation in circular profile, low and medium pressure systems.

**Fitting:**

In the overpressure and negative pressure parts of the systems, excluding air polluted with dust, especially fibrous dust.

**Construction:**

The damper is made of galvanized steel sheet in a form of a circular duct with a rotational regulated leaf adjusted using a regulation mechanism which can be fixed at any position. Flangeless face edge finish, suitable for connecting with spiro or flex type ducts.

**Material:**

Galvanized steel sheet.

**Air flow regulation:**

As a standard, the damper is fitted with a manual adjustment mechanism. On demand the damper can be adapted to automatic adjustment using an actuator.

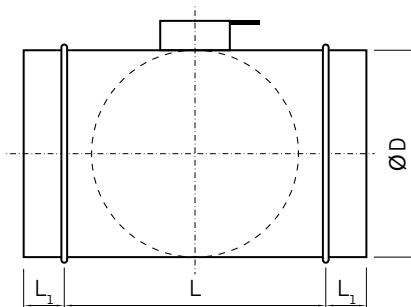
**Dimensions and type marking:****PJO****Production range:**

ØD	100	125	160	200	250	315	400	500	630
L	200	200	200	220	220	315	400	500	630
L <sub>1</sub>	45	45	45	45	45	65	65	65	65

**Product marking:****PJO-200-S**

**Regulation type:**  
Standard – manual  
S – with an actuator

**Diameter ØD**

**Type**

**Example of an order:****PJO-200**

One leaf circular damper, diameter Ø200 mm,  
manual regulation